



CORE PREP OPERATOR'S MANUAL

**CPST1415E1
SCRAPER**

OCTOBER, 2024

Table of Contents

Description	Page No.
1. General safety information.....	6
1.1. Safety rules for operating the floor stripper.....	6
1.2. Labels on the CPST1415E1 floor stripper.....	7
1.3. Machine type identification label CPST1415E1.....	7
2. Operating the machine.....	8
2.1. Range of applications.....	8
2.2. Operational function.....	8
2.3. Preparation (carpet, coverings).....	8
2.4. Adjusting the weights.....	9
2.5. Adjusting the handle.....	9
2.6. Changing the blades.....	9
3. Trouble Shooting.....	10
4. Technical Data.....	11
5. Notes.....	12
6. Warranty.....	14

Product Overview

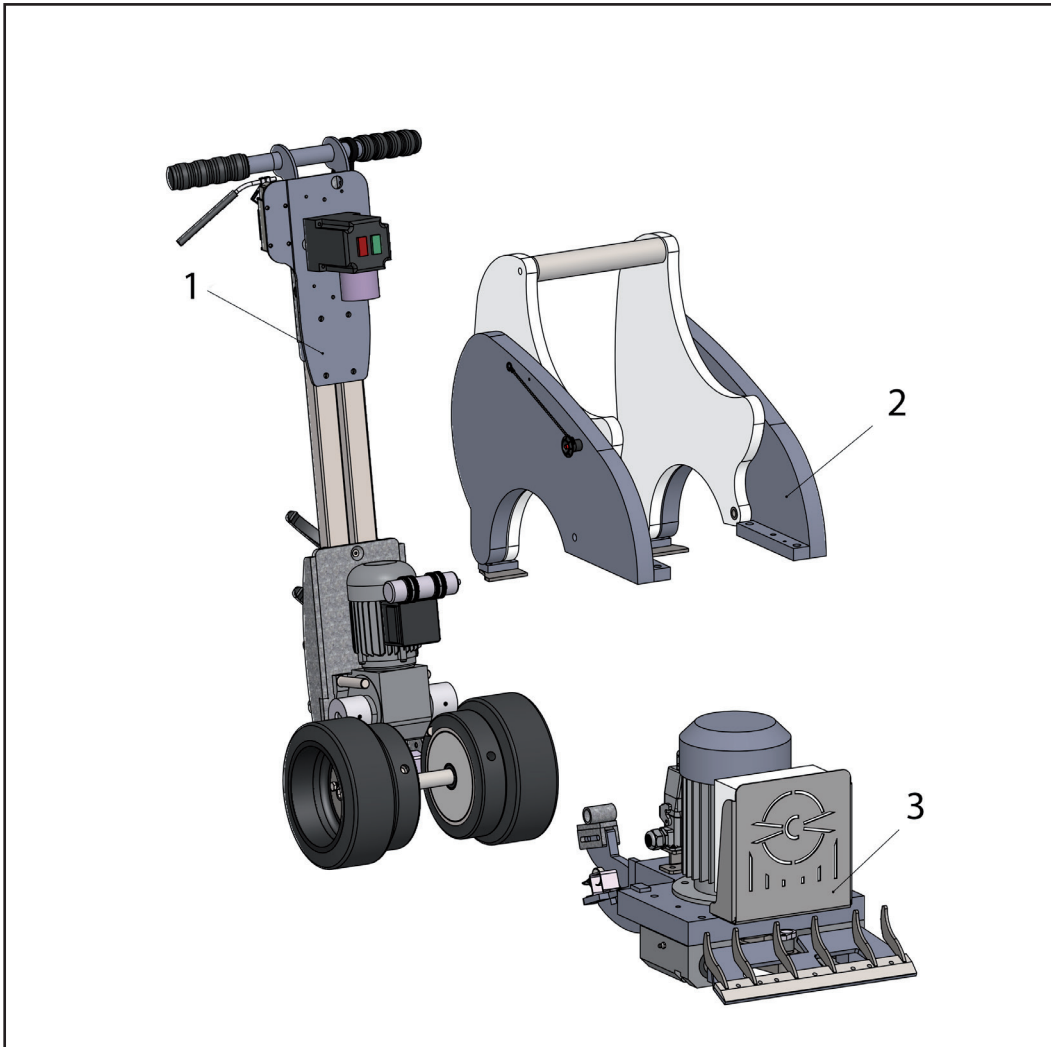

Product Overview

- 1 Handle
- 2 Weights
- 3 Motor frame & blade attachment

1. General safety information

1.1 Safety rules for operating the floor stripper



Information

The CPST1415E1 floor stripper has been developed while taking all relevant applicable safety standards into account. The technical safety precautions must not be removed or changed under any circumstances. Before starting work, these operating instructions must be read by all persons who work with, maintain or care for the machine. When operating the floor stripper, the following points should also be observed:



WARNING!

- The CPST1415E1 floor strippers may only be operated with all protective devices.
- The power must be disconnected when transporting, cleaning, repairing or maintaining the machine. This also applies to tool changes.
- The tool must be removed before the machine is transported.
- Only tools supplied or approved by Diamond Products may be used.
- The machine operator must not leave the machine at any time during operation.
- Before leaving the floor stripper, the machine operator must shut down the engine and secure the device against unintentional movements. In addition, the power plug must be disconnected.
- If unusual running noises or increased vibrations are registered during operation of the CPST1415E1, the machine must be switched off immediately and the cause of the irregularity must be explored.
- After maintenance and repair work, the protective devices must be properly reinstalled.
- Protection equipment for both eyes and ears must be worn by the machinist.
- The machinist must wear safety shoes with steel toecaps.
- If there is a lot of dust in closed rooms, the floor stripper must be operated with an extraction system.



ATTENTION!

Depending on the type of floor (floor coating) stripping can produce gases/dust. The operator must be held responsible if these generated gases/dust are dangerous and if protection is necessary.

Stripping floors containing asbestos is especially dangerous and can cause health problems. Special masks must be worn which keep the breathing air clean. A dust collector must be used and should be equipped with filters suitable for asbestos dust.

The area to be stripped should be brushed clean. This ensures pins, screws and bolts protruding from the floor can be better recognized. Thus eliminating danger of the tools colliding with the parts.

1.2 Labels on the CPST1415E1 floor stripper



Labels on the CPST1415E1 floor Stripper

- 1 Read all information carefully. Safety glasses, earmuffs & shoes must be worn.
- 2 Warning - electrical voltage.
- 3 Warning - risk of cuts through moving blades.
- 4 Heavy load warning.
- 5 The control cabinet must only be opened by authorized trained personnel!
- 6 Before opening, switch off and pull out the mains plug.

1.3 Machine type identification label CPST1415E1



Machine type ID label CPST1415E1

2 Operating the machine

2.1 Range of applications



Information

The CPST1415E1 sets new standards for floor stripper performance.

The extra strong design enables floor coverings to be peeled off and removed on dry floors. Floor coverings are such as carpets, tiles, parquet, vinyl coverings, coatings, paint residues or similar. Only tools offered by Diamond Products (blades, chisels) may be used. The CPST1415E1 can only be used outside of closed rooms in dry weather.

2.2 Operational function

The CPST1415E1 floor stripper removes glued floor coverings with the help of a vibrating blade. The blade is moved by an electric motor.

The floor stripper is propelled forwards by a second gear motor.

The blade starts up automatically when the stripper is switched on and can be stopped quickly with the emergency stop switch.

The blade drive starts as soon as the machine is switched on via the green switch and can easily be switched off by depressing the red emergency switch (see 2.5 Handle Nr 48) .

The drive unit motor starts by pressing the dead man switch (No.44) on the handle bar and then initially runs in freewheel mode.

If the handle bar is pushed forward the drive unit starts to work and the machine starts to move. The drive can be locked in the moving position by stepping on the foot lever at the bottom of the handle bar.

After a power failure, the CPST1415E1 floor stripper must be switched on again. The CPST1415E1 can be adapted to different floor conditions thanks to the three positioning options for the inner weights. A lot of pressure on the drive wheels allows more weight on the tools for more effective covering removal.

- Self propulsion Drive Unit, manual or automatic.
- Directly driven RAM action mechanism (maintenance-free).
- Height-adjustable handle.
- Crane lifting points.
- Protective cover.
- Ergonomic control handle including all controls and dead man's switch.
- Main weight foldable in 3 stages.

2.3 Preparation (carpet, coverings)

It is sufficient to cut the covering into strips approx. 35 cm wide. Wider strips do not save time. In order to be able to start scraping, a strip is first cut across the designated area. Then lift the floor covering slightly in order to get the blade underneath it.

We recommend that you cut the first strip at right angles to the main working direction. By so doing, access to the adjacent strips is made easier.

Cut the strips smaller if the floor covering is bonded very securely, e.g. with an epoxy adhesive. The blades are sharpened by the floor pavement. Therefore the blade only has to be changed if it is twisted, rounded or becomes worn.

The driving wheels are subject to wear. They have to be changed if necessary.

2.4 Adjusting the weights

The two center weights can be locked in three different positions.

The locking bolt (Article No.111) is situated on the right hand outside weight. The bolt must be pulled out before changing the position.

Position 1:	Reinforced weight on the rear wheels. The drive wheels do not spin and the speed is increased.
Position 2:	Middle position and possibility of crane transport.
Position 3:	Weight reinforced on the tool. This prevents the tool from lifting off and sliding over the base.

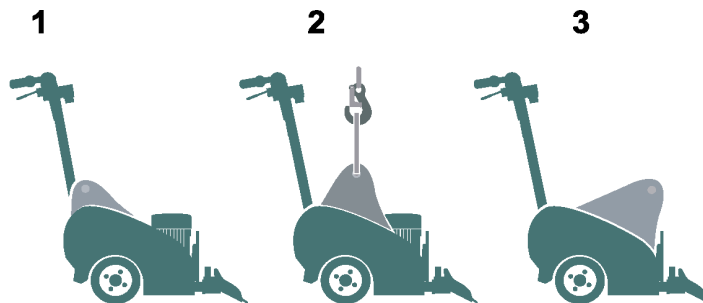

2.5 Adjusting the handle

The height of the handle bar can be adjusted to adapt the machine to the stature of the operator. To adjust the inclination, loosen the two screws (see Article Nr.40) at the base of the handle.

2.6 Changing the blades



WARNING!

Before starting work, disconnect the plug from the mains. Use gloves.

- ▶ Lock the weights as in Pos 1 (see 2.4 Adjusting the weights).
- ▶ Tip the machine until it rests in a stable position.
- ▶ Clean and loosen the screws of the blade mounting
- ▶ Warning! Set the wrench at a position opposite to the blade to avoid injury.
- ▶ Carefully remove the blade

Make sure that the blade fits exactly into the support.

On normal and hard subfloors the bevel of the blade should show upwards (B). On soft subfloors the bevel should show downwards (A).

Position of blade bevel when changing		
	A. Downwards facing	For soft subfloors
	B. Upwards facing	For normal and hard flooring

Tighten the screws of the blade mounting again.

3 Trouble Shooting

Trouble Shooting		
Problem	Possible cause	Solution
Machine does not run	<ul style="list-style-type: none">– Power supply disconnected– Blown fuse– Defect cable	<ul style="list-style-type: none">– Check power supply.– Have machine repaired by a qualified electrician, change parts
Bad performance	<ul style="list-style-type: none">– Blade is blunt	<ul style="list-style-type: none">– Change blade
Excessive vibration	<ul style="list-style-type: none">– Machine parts are worn out	<ul style="list-style-type: none">– Return machine for repair or service

4 Technical Data

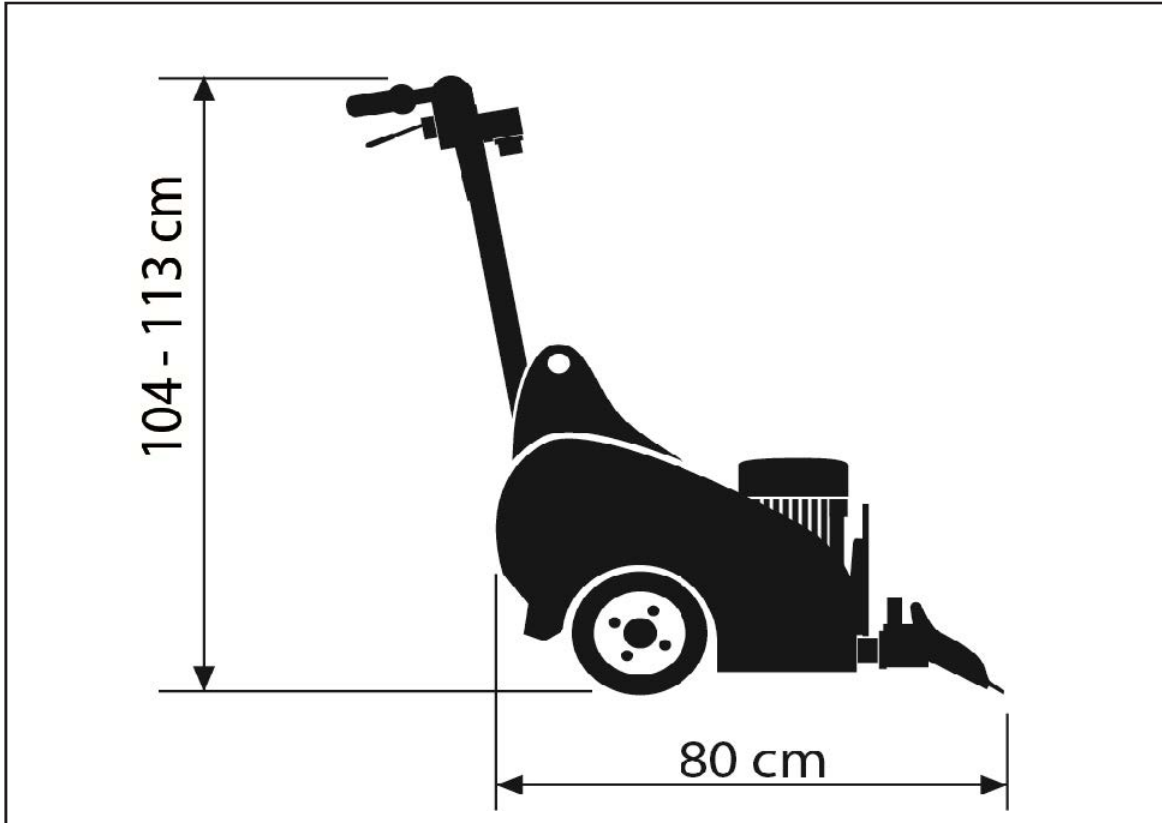

Technical Data	
Parameter	Value
Maximum working width	350 mm (17.7 in)
Length	81 cm (31.9 in)
Width	50 cm (19.6 in)
Height	104-113 cm (41-44.5 in)
Weight	225 kg (466/495 Lbs)
Power supply	110 / 115 V / 230 V
Power consumption	21 / 18.9 / 11.2 A
Average value of acceleration ah_v^*	9.2 m/s ²
Noise level L_{wa}^*	99 dB(A)
Noise level L_{eq}^*	87 dB(A)

*Measured values / data: All specifications are approximate and subject to confirmation. They should only be used as a guide.

This image shows a full page of blank, lined paper. It features approximately 20 horizontal blue or grey lines spaced evenly apart, typical of notebook paper. The lines extend across the entire width of the page, leaving small margins at the top and bottom. There are no vertical lines, text, or other markings present.

EQUIPMENT AND PARTS WARRANTY

Diamond Products warrants all equipment manufactured by it against defects in workmanship or materials for a period of one (1) year from the date of shipment to Customer.

The responsibility of Diamond Products under this Warranty is limited to replacement or repair of defective parts at Diamond Products' Elyria, Ohio factory, or at a point designated by it, of such parts as shall appear to us upon inspection at such parts, to have been defective in material or workmanship, with expense for transportation and labor borne by Customer.

In no event shall Diamond Products be liable for consequential or incidental damages arising out of the failure of any Product to operate properly.

Integral units such as engines, electric motors, batteries, transmissions, etc., are excluded from this Warranty and are subject to the prime manufacturer's warranty.

THIS WARRANTY IS IN LIEU OF ALL OTHER WARRANTIES, EXPRESSED OR IMPLIED, AND ALL SUCH OTHER WARRANTIES ARE HEREBY DISCLAIMED.



333 Prospect Street, Elyria, Ohio 44035
(440) 323-4616 • (800) 321-5336 • Fax (800) 634-4035
www.diamondproducts.com