

**DIAMOND PRODUCTS
SPECIALTY EQUIPMENT
MANUFACTURING
DIVISION**

**PARTS BOOK
HYDRA-GEN 115 POWER UNIT
PART# CC-HG-SK
CATALOG# 80490**



REVISED: 11/30/05

Table of Contents

<u>Description</u>	<u>Page</u>	<u>No.</u>
Power Unit.....	4	- 5
Electrical Panel.....	6	- 7
Operating Instructions.....	8	- 9
Specifications.....	10	
Notes.....		11
Warranty.....		12

CS-HG-SK PARTS LIST DRAWING # 1

Part Number	Description	Qty. Required
2502082	Flow Control	1
2502511	Belt / Goodyear Eagle	1
2502568	QD Bushing SK-1 -1 /2	1
2502569	Helical Sprocket	1
2502570	Helical Sprocket 1-1/2 SK Bushing	1
2503446	4" Rain Cap	1
2601635	Right Hand Pump 2.77CI	1
2702736	Muffler	1
2703126	Muffler Kit	1
2703137	Starter	1
2703157	Fuel Filter	1
2703158	Engine Oil Filter	1
2800494	Transformer 5.0KVA	1
2802571	Battery	1
3200689	On/Off Manifold	1
3200709	5" Sight Guage w/ Thermometer	1
3200712	3/4" Steel Ball Valve	1
3200718	3 x 1.5 Strainer	1
3200723	Bearing Block	1
3200724	Comp Line Filter	1
3200728	1-1/2" Ball Valve	1
3200729	8" Filler Breather	1
3200730	Filter Element	1
3200731	Tank Top Filter	1
3200740	5000 PSI Guage	1
3200749	Flow Meter	1
3201212	1-1/2 GM 90Deg St Elbow	1
3201283	3/4" All Male Pipe Tee	1
3201610	3/4" Relief Valve	1

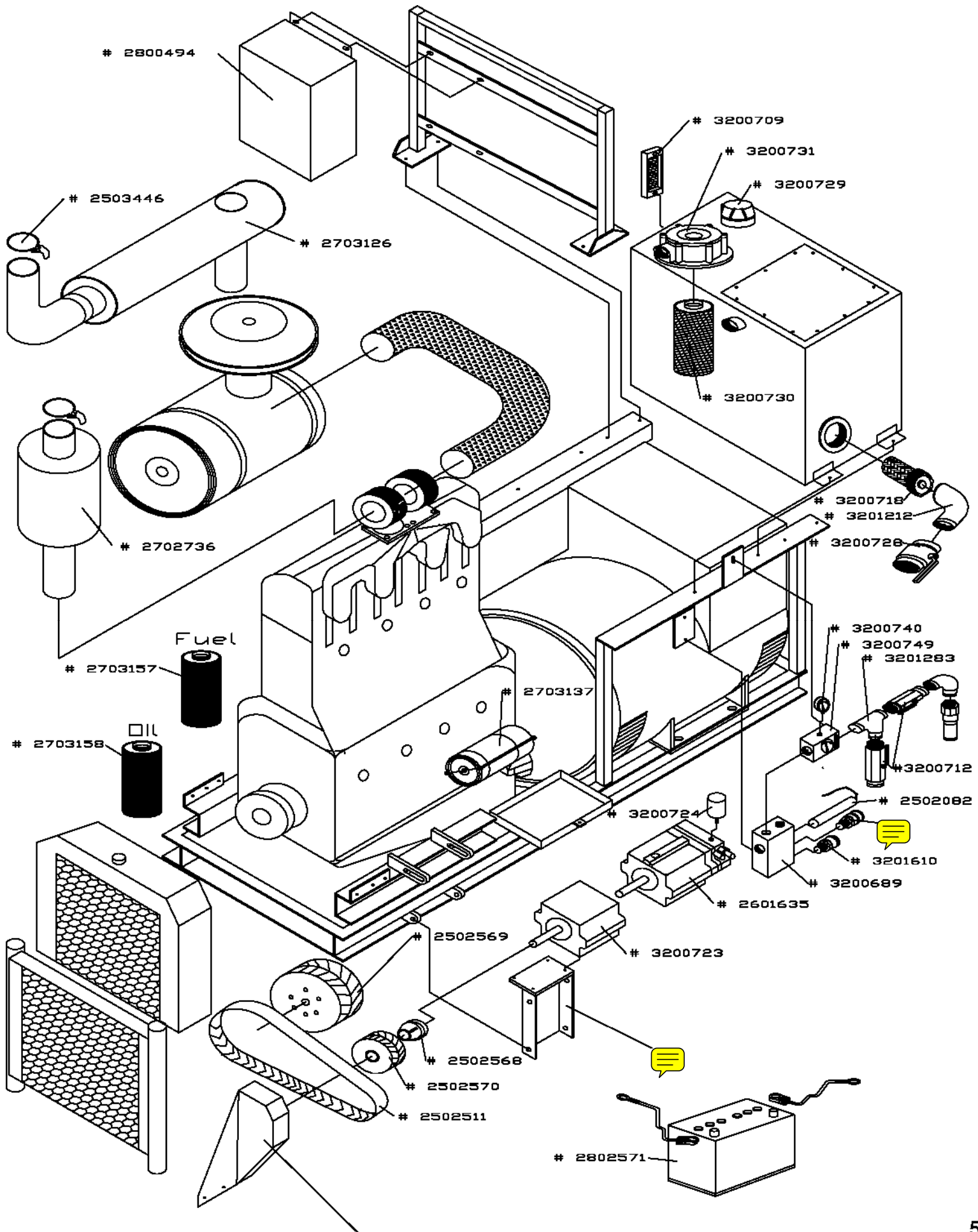

**CS-HG-SK PARTS LIST
DRAWING # 2**

Part Number	Description	Qty. Required
2800492	Breaker 20Amp 11 0Volt	1
2800493	Breaker 30Amp 11 0Volt	1
2800495	Receptacle 30Amp 480 Volt	1
2800496	Receptacle 30Amp 120Volt	1
2800497	Breaker 70Amp 480 Volt	1
2800500	Breaker 15Amp 480 Volt	1
2800584	Electrical Box, Watertight	1
2800675	Switch-Dbl Throw-Dbl Pole	1
2800676	16/4 SO Cord	1
2800677	Cord Connector 3/8"-1/2"	1
2800678	Plug 12V	1
2800679	Receptacle 12V	1
2802575	GFI 20Amp	1
2802931	Control Panel 100Amp	1

Electrical Panel

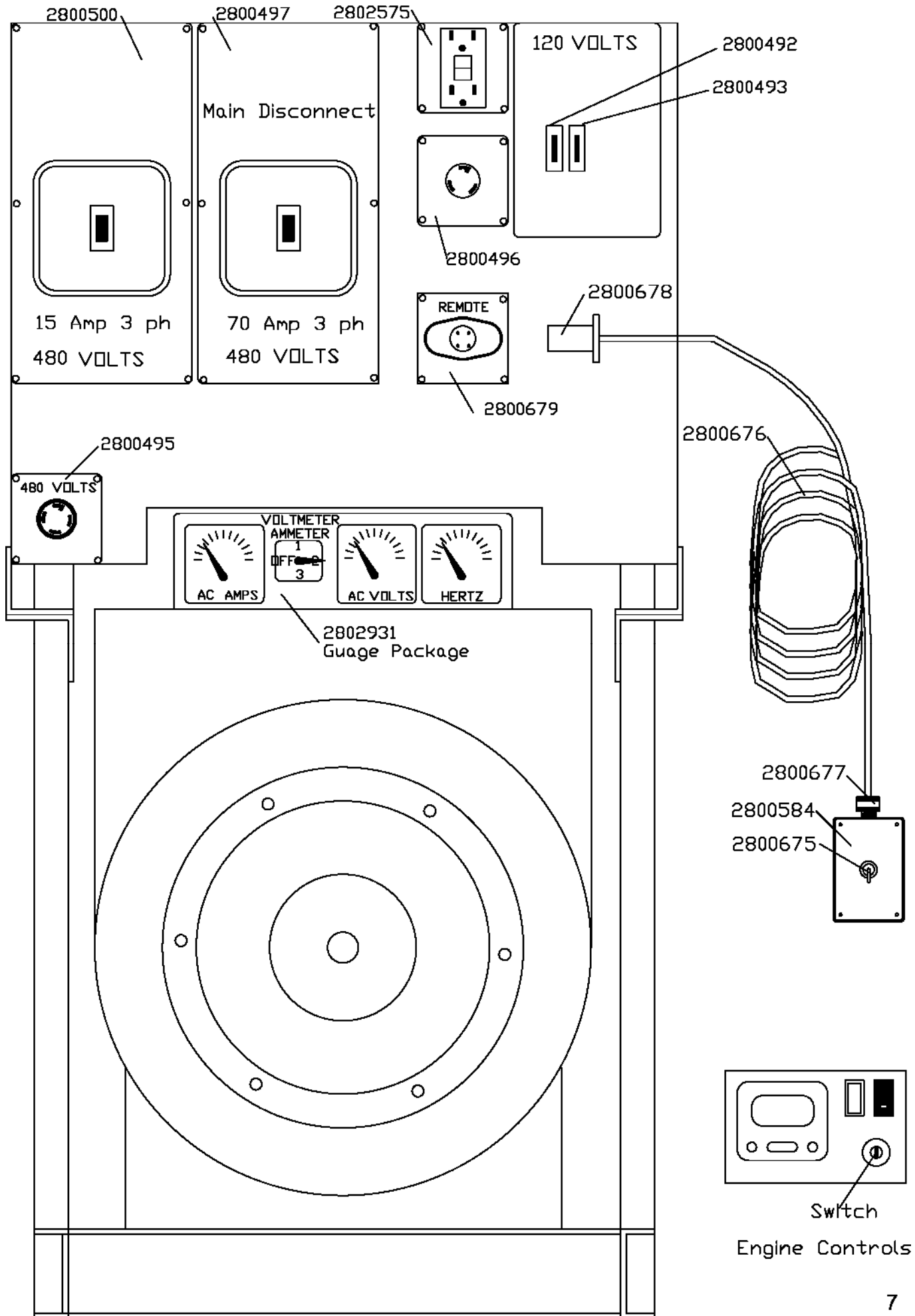

OPERATING INSTRUCTIONS
CC-HG-SK
(With Electronic Controls)

To Start Engine:

Push Rocker Switch To Turtle Position
TURN Ignition Key To Start Position. Release Key When Engine Starts.
Push Rocker Switch To Hare Position. For **ALL** Functions Related To This Unit

To Shut Off Engine:

Return Rocker Switch To Turtle Position
Let Idle For 2 Minutes
Turn Ignition Key Off

WARNING:
Do NOT Use Generator Or Hydraulics
With The Engine Running In Turtle Position!

For Generator Use:

With Engine Running In The Hare Position,
Engage The 70Amp Main Breaker. Now You Are Ready For **ALL** Generator

For Hydraulic Use:

With Engine Running In The Hare Position,
You Will Have Live Hydraulics.

WARNING:
Do NOT Attempt To Use The Hydraulics
When The Engine Is In The Turtle Position!

**OPERATING INSTRUCTIONS
CC-HG-SK
(With Electronic Controls)**

Adjusting Hydraulic Pressure And Flow:

This Unit Is Equipped With Electronic Controls
The **Pressure** And **Flow** Are Adjustable On This Unit

**WARNING:
Do NOT Adjust Pump!**

To Regulate The Flow, The On/Off Switch Can Be Ramped Up And Down To Control The Gallons Per Minute. This Can Be Done At The Working Tool

All **Pressure** Adjustments Are Made At The Unit **ITSELF**.
Use The Lower Regulation Knob To Make This Adjustment

Maximum Flow Adjustments Can Also Be Made With The Upper Regulator Knob

**NOTE:
This Unit Is Equipped With A
Flow Meter and Pressure Gauge**

**WARNING:
Be Sure That When You Are Using The Generator Only;
That The Switch To Turn On The Hydraulics
Is In The OFF Position!**

Electrical Outlets:

Description:

70Amp Main Breaker 480 Volt 3Ph
15Amp Breaker 480 Volt 3Ph
30Amp Breaker 110Volt 1Ph
20Amp Breaker 110Volt 1Ph

**CC-HG-SK
SPECIFICATION SHEET**

Dimensions:

Length 78"
Height 72"
Frame Width 30"
Weight 3800

Engine:

115HP John Deere
Water Cooled

Generator:

50KW Lima Mac 480Volt 3
Phase

Hydraulic Pump:

Max Pressure 3000
Max Flow 28gpm
Belt Driven
40 Gallon Oil Tank
Suction and Return Filters
Heat Exchanger, Air Over Oil

EQUIPMENT AND PARTS WARRANTY

Diamond Products warrants all equipment manufactured by it against defects in workmanship or materials for a period of one (1) year from the date of shipment to Customer.

The responsibility of Diamond Products under this Warranty is limited to replacement or repair of defective parts at Diamond Products' Elyria, Ohio factory, or at a point designated by it, of such parts as shall appear to us upon inspection at such parts, to have been defective in material or workmanship, with expense for transportation and labor borne by Customer.

In no event shall Diamond Products be liable for consequential or incidental damages arising out of the failure of any Product to operate properly.

Integral units such as engines, electric motors, batteries, transmissions, etc., are excluded from this Warranty and are subject to the prime manufacturer's warranty.

THIS WARRANTY IS IN LIEU OF ALL OTHER WARRANTIES, EXPRESSED OR IMPLIED, AND ALL SUCH OTHER WARRANTIES ARE HEREBY DISCLAIMED.



333 Prospect Street, Elyria, Ohio 44035
(440) 323-4616 • (800) 321-5336 • Fax (440) 323-8689
www.diamondproducts.com