



**TILE SAW  
PARTS LIST**

**MODEL  
CC912TS**

JAN 2018



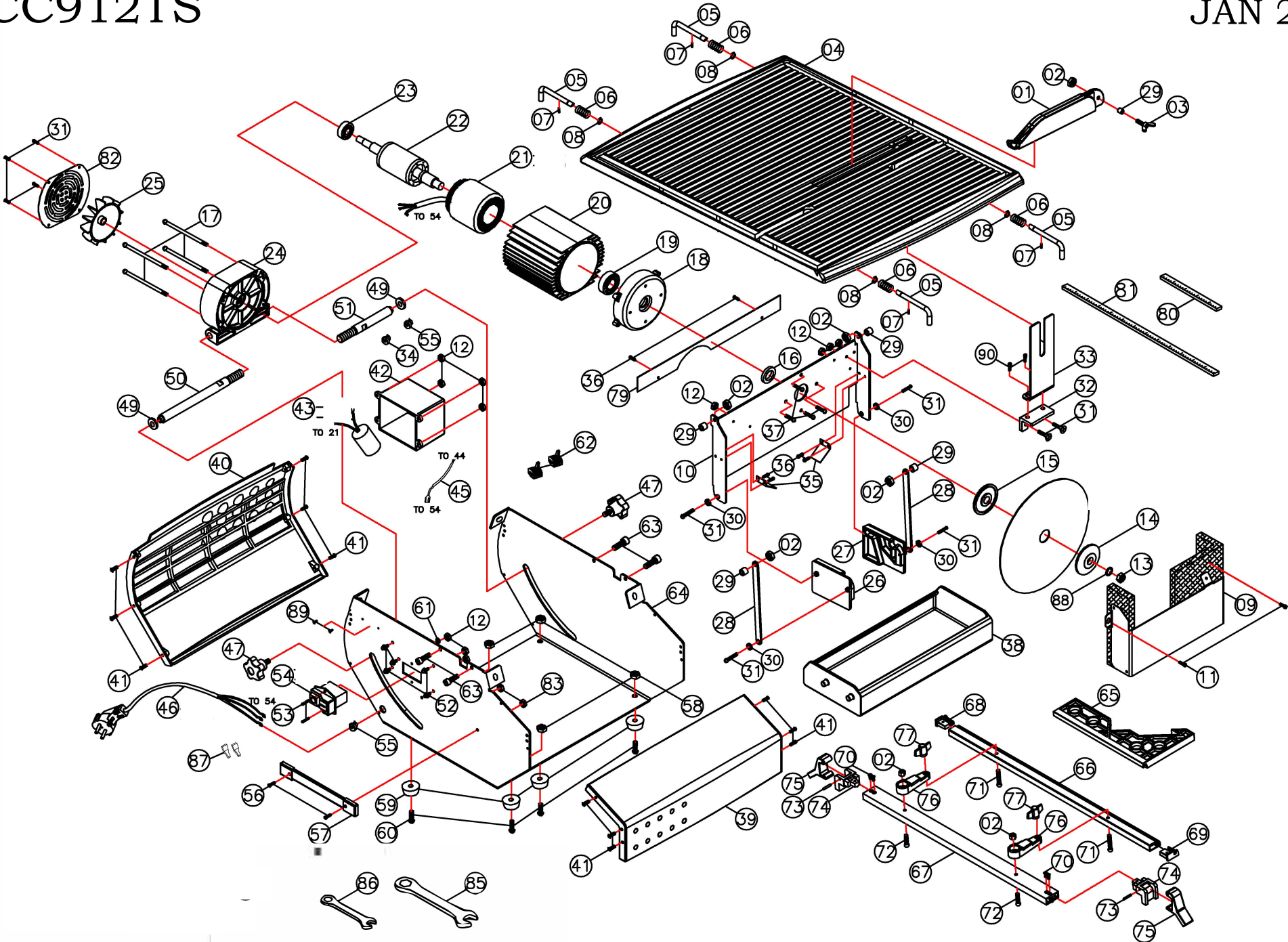

## CC912TS 110V PARTS LIST JAN 2018

ITEM	PART NO.	QTY	DESCRIPTION
1	6078624	1	INNER SAFETY COVER
2	6078625	7	NYLOCK NUT (M6xP1.0)
3	6078626	1	THUMB SCREW (M6x20)
4	6078627	1	TABLE (BLACK)
5	6078628	4	PLUNGE LOCK LEVER
6	6078629	4	SPRING (Ø1xØ8.1x5Tx25.7L)
7	6078630	4	ROLL PIN (Ø3.5x10)
8	6078631	4	EXTERNAL CIRCLIP (S-8)
9	6078632	1	SHROUD
10	6078633	1	MOTOR PLATE
11	6078634	2	SOCKET CAP SCREW (M4x12xP0.7)
12	6078635	11	HEX NUT (M4xP0.7)
13	6078636	1	HEX NUT (M12xP1.75)
14	6078637	1	OUTER FLANGE
15	6078638	1	INNER FLANGE (Ø25.4)
16	6078639	1	OIL SEAL (Ø20xØ32x5)
17	6078640	4	PHMS (M5x150xP0.8)
18	6078641	1	MOTOR FRONT COVER
19	6078642	1	BALL BEARING (6004)
20	6078643	1	MOTOR HOUSING
21	6078644	1	STATOR 110V
22	6078646	1	ARMATURE
23	6078647	1	BALL BEARING (6201)
24	6078648	1	MOTOR REAR COVER
25	6078649	1	FAN (BLACK)
26	6078650	1	TRAY BRACKET-LEFT
27	6078651	1	TRAY BRACKET-RIGHT
28	6078652	2	SUPPORT ROD
29	6078653	5	SCREW SWIVEL (Ø6.2xØ10x10)
30	6078458	4	FLAT WASHER (Ø4xØ10x1)
31	6078655	10	PHMS (M4x8xP0.7)
32	6078656	1	SEPARATOR BRACKET
33	6078657	1	SEPARATOR
34	6078658	1	CABLE GLAND (SB7R-3)(6P3-4)
35	6078659	2	SPLASH GUARD
36	6078660	6	PHMS (M4x6xP0.7)
37	6078661	4	PHMS (M5x10xP0.8)
38	6078662	1	WATER TRAY
39	6078663	1	FRONT BEVEL BRACKET

## CC912TS 110V PARTS LIST JAN 2018

40	6078664	1	REAR BEVEL BRACKET
41	6078665	12	TRUSS HD TAPPING SCREW-A (M4x16)
42	6078666	1	PLASTIC BOX
43	6078667	1	CAPACITOR
45	6078669	1	WIRE LEAD (1015-16#10CM)
46	6078670	1	PWR CABLE
47	6078672	2	THUMB SCREW (M8x12)(BLACK)
49	6078673	2	FLAT WASHER (Ø13xØ24x2.5)
50	6078674	1	REAR STRUT (LONG)
51	6078675	1	REAR STRUT (SHORT)
52	6078676	5	PHMS -W/WASHER (M4x16xP0.7)
53	6078677	2	FHMS (M4x20xP0.7)
54	6078678	1	MOTOR SWITCH 110V
55	6078680	2	CABLE GLAND (SB6R-3)(6P-4)
56	6078681	2	FHMS (M5x15xP0.8)
57	6078682	1	STRAP COVER
58	6078683	4	NYLOCK NUT (M8xP1.25)
59	6078684	4	RUBBER FOOT
60	6078685	4	PHMS (M8x16xP1.25)
61	6078686	1	EXTERNAL STAR WASHER (M5)
62	6078687	2	THREE WIRE PUSH IN CONNECTOR
63	6078688	4	SOCKET CAP SCREW (M6x25xP1.0)
64	6078689	1	BASE (ORANGE-021C)
65	6078690	1	ANGULAR GUIDE PLATE (BLACK)
66	6078691	1	RULER
67	6078692	1	RULER CLAMP BAR
68	6078693	1	RULER END PLUG-LEFT
69	6078694	1	RULER END PLUG-RIGHT
70	6078695	4	FHTS -B (M4x8)
71	6078696	2	PHMS (M6x30xP1.0)
72	6078697	2	PHMS (M6x20xP1.0)
73	6078698	2	ROLL PIN (Ø3x30)
74	6078699	2	CLAMP BODY
75	6078700	2	CLAMP HOOK
76	6078701	2	PARALLEL BRACKET
77	6078702	2	WING NUT
79	6078704	1	RETAINING PLATE
80	6078705	1	MITER SCALE
81	6078706	1	MITER SCALE
82	6078707	1	TAIL COVER





## **EQUIPMENT AND PARTS WARRANTY**

Diamond Products warrants all equipment manufactured by it against defects in workmanship or materials for a period of 90 Days from the date of shipment to Customer. The responsibility of Diamond Products under this Warranty is limited to replacement or repair of defective parts at Diamond Products' Elyria, Ohio factory, or at a point designated by it, of such parts as shall appear to us upon inspection at such parts, to have been defective in material or workmanship, with expense for transportation and labor borne by Customer. In no event shall Diamond Products be liable for consequential or incidental damages arising out of the failure of any Product to operate properly.

THIS WARRANTY IS IN LIEU OF ALL OTHER WARRANTIES, EXPRESSED OR IMPLIED, AND ALL SUCH OTHER WARRANTIES ARE HEREBY DISCLAIMED.



333 Prospect Street, Elyria, Ohio 44035  
(440) 323-4616 • (800) 321-5336 • Fax (800) 634-4035  
[www.diamondproducts.com](http://www.diamondproducts.com)